

# Solutran<sup>®</sup>hemo BLOOD bags

by Meditalia

your solution

## For human blood and blood components

### Summary table of performances of MEDITALIA blood bags for the collection of 450 ml of blood

ITEM	TEST RESULT
Resistance to centrifugation (5,000 g x 10 min)	No leakage, no distortion
Resistance to stretch (20 N for 5 seconds)	No breakage, no deterioration
Leakage (67 kPa for 10 min)	No loss in walls, seals and joints
Emptying under pressure (40 kPa internal pressure)	Completed in 40 sec (requirement <2 min)
Speed of filling (9.3 kPa pressure)	Completed in 2.5 min (requirement <8 min)
Resistance to temperature variations (from -80 to +50 °C)	Full compliance with tests for resistance to centrifugation, resistance to stretch, leakage, emptying under pressure and speed of filling
Transparency (opalescent solution with absorbance = 0.4)	Easy appreciation of turbidity
Red cell hemolysis at the end of storage (42 days)	≤0.3%; n=3
Optimal pH of platelets after 7 days of storage	6.88 - 7.12; n=3

# Solutran<sup>®</sup>hemo BLOOD bags

by Meditalia

your solution





# Set for human blood and blood components collection

## Solutran<sup>®</sup>hemo BLOOD bags

by Meditalia

your solution

### Non reopening clamp



Safety system to guarantee the isolation of the sampling bag after filling.



### Color coded clamp

Allows the identification of the different kind of clamp.

### Safety sampling bag

Useful container for the collection of contamination free pre-donation sampling for laboratory testing.

### Vacuum blood connector needle

- Reduces potential exposure of the sampling needle during the handling.
- The safety hinged cover isolates the sampling needle from direct exposure.



### Blood donor needle and needle protector

- High quality and consistent performance Japanese needle technology.
- Silicon coating on internal and external surface of cannula.
- Protection of the needle to reduce the risk of needle stick injury.



- Flexible blood collection tubes
- Efficient transfer of blood components into the different containers

### Break off part

- Easy clip-tip fracture



### All configurations are available:

- with or without a 40 ml pre-donation "safety sampling bag"
- with or without needle protector

### Single blood bag containing CPDA-1

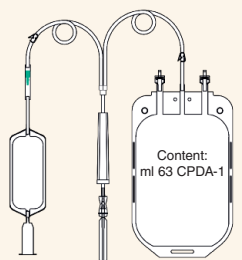

### Double blood bag containing CPDA-1

It can be used to prepare red blood cells and plasma

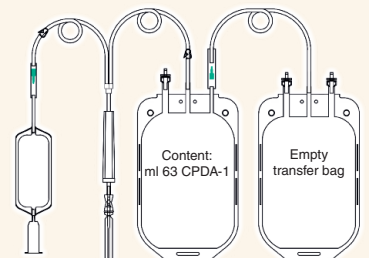

### Triple blood bag containing CPD and SAG-M

It can be used to prepare red blood cells, plasma and platelets

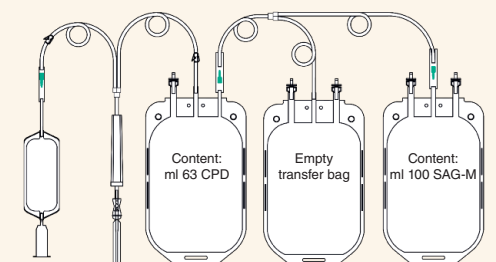

### Quadruple blood bag containing CPD and SAG-M

It can be used to prepare buffy-coat depleted red blood cells, plasma and buffy-coat (which can be used to prepare platelets)

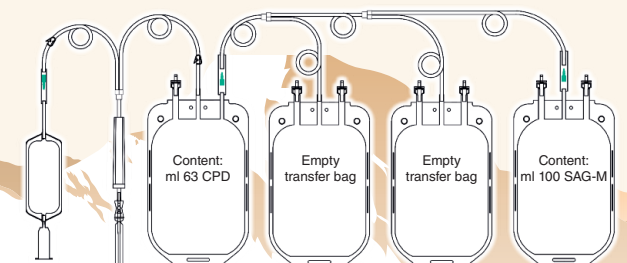

### Label

- PVC material
- Tamper proof
- Convenient to write on

- Optimal flexibility and transparency of the plastic material
- Excellent handling characteristics.

### Optimal gas permeability

Average oxygen permeability of Solutran Hemo<sup>®</sup> plastic bag for platelet storage,  
 $O_2$  TR = 680 cc/m<sup>2</sup>•24h•atm;  $CO_2$  TR = 10205 cc/m<sup>2</sup>•24h•atm.  
 Test carried out in compliance with the European Pharmacopoeia.

**CPDA-1:** citrate, phosphate, dextrose, adenine  
**CPD:** citrate, phosphate, dextrose  
**SAG-M:** sucrose, adenine, glucose, mannitol

# BLOOD BAG SYSTEMS

CODE	CONFIG	SOLUTION	PRIMARY CONTAINER VOLUME	SATELLITE CONTAINER VOLUME 1	SATELLITE CONTAINER VOLUME 2	SATELLITE CONTAINER VOLUME 3	SAMPLING DEVICE	NEEDLE PROTECTOR	NAME
71A0000000	Single	CPDA-1	450 ml	N/A	N/A	N/A	N	N	Single Blood Bag
81A0000000	Single	CPDA-1	450 ml	N/A	N/A	N/A	Y	N	Single Blood Bag with sampling device
71A1000000	Single	CPDA-1	450 ml	N/A	N/A	N/A	N	Y	Single Blood Bag with needle protector
81A1000000	Single	CPDA-1	450 ml	N/A	N/A	N/A	Y	Y	Single Blood Bag with sampling device and needle protector
72A0400000	Double	CPDA-1	450 ml	450 ml	N/A	N/A	N	N	Double Blood Bag
82A0400000	Double	CPDA-1	450 ml	450 ml	N/A	N/A	Y	N	Double Blood Bag with sampling device
72A1400000	Double	CPDA-1	450 ml	450 ml	N/A	N/A	N	Y	Double Blood Bag with needle protector
82A1400000	Double	CPDA-1	450 ml	450 ml	N/A	N/A	Y	Y	Double Blood Bag with sampling device and needle protector
73C040S000	Triple	CPD/SAGM	450 ml	450 ml	450 ml	N/A	N	N	Triple Blood Bag
83C040S000	Triple	CPD/SAGM	450 ml	450 ml	450 ml	N/A	Y	N	Triple Blood Bag with sampling device
73C140S000	Triple	CPD/SAGM	450 ml	450 ml	450 ml	N/A	N	Y	Triple Blood Bag with needle protector
83C140S000	Triple	CPD/SAGM	450 ml	450 ml	450 ml	N/A	Y	Y	Triple Blood Bag with sampling device and needle protector
73A0440000	Triple	CPDA-1	450 ml	450 ml	450 ml	N/A	N	N	Triple Blood Bag
73A1440000	Triple	CPDA-1	450 ml	450 ml	450 ml	N/A	N	Y	Triple Blood Bag with needle protector
83A1440000	Triple	CPDA-1	450 ml	450 ml	450 ml	N/A	Y	Y	Triple Blood Bag with sampling device and needle protector
74C044S000	Quadruple	CPD/SAGM	450 ml	450 ml	450 ml	450 ml	N	N	Quadruple Blood Bag
84C044S000	Quadruple	CPD/SAGM	450 ml	450 ml	450 ml	450 ml	Y	N	Quadruple Blood Bag with sampling device
74C144S000	Quadruple	CPD/SAGM	450 ml	450 ml	450 ml	450 ml	N	Y	Quadruple Blood Bag with needle protector
84C144S000	Quadruple	CPD/SAGM	450 ml	450 ml	450 ml	450 ml	Y	Y	Quadruple Blood Bag with sampling device and needle protector
74A0444000	Quadruple	CPDA-1	450 ml	450 ml	450 ml	450 ml	N	N	Quadruple Blood Bag
74A1444000	Quadruple	CPDA-1	450 ml	450 ml	450 ml	450 ml	N	Y	Quadruple Blood Bag with needle protector
84A1444000	Quadruple	CPDA-1	450 ml	450 ml	450 ml	450 ml	Y	Y	Quadruple Blood with sampling device and needle protector